



deLIGHT Glow Baton Instruction Sheet

Thank you for purchasing a glow baton! We are excited to see what you will do with it - send us pictures or videos if you want to be featured on our social media!

The glow baton is made up of 3 main parts - the body of the baton, the glow sticks, and the spacers. Information about these parts are listed below:

The body (shaft, ends, twist-lock plug)

- The twist lock plug rotates to open and close. Twist-locking the plug ensures that the glow sticks will stay in place at all times.

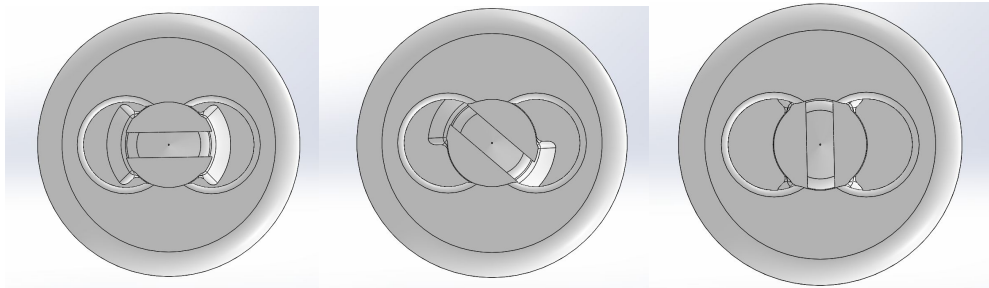



- The plug can be taken out with fingers or with a small object like a hairpin or key.
- The shaft and ends are very durable and can withstand hard drops.
- The shaft will get scuffed up from being dropped on concrete - this will not affect the shaft strength.

Glow Sticks

- The baton is designed to hold typical 8 inch glow stick bracelets - no special glow sticks required!
- Glow bracelets can be purchased at party supply stores and dollar stores or online. We get our 8" glow bracelets at glowuniverse.com.
- The brightest glow colors are green, yellow, blue and red.
- In freezing temperatures the glow sticks will not be as bright.

Spacers

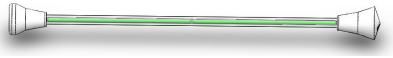
- Spacers are used to keep the glow sticks in place so they do not shift while being twirled.
- You should have received two sets of spacers with your baton - the second set is a backup in case some get lost.
- On the back of this sheet is a table describing the spacer placement for each baton length.

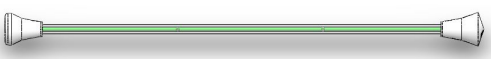
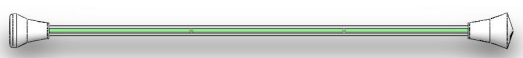
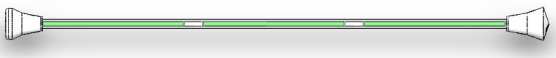
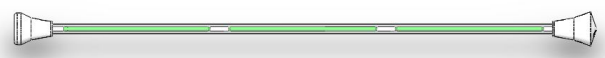
Baton length	# of glow sticks	Big end spacer (end with plug)	1st middle spacer	2nd middle spacer	Small end spacer	Image (*not to scale)
20"	2	1 "	None	N/A	1 $\frac{3}{8}$ "	
22"	2	1"	2"	N/A	1 $\frac{3}{8}$ "	
24"	2	2"	2"	N/A	2 $\frac{3}{8}$ "	
26"	3	None	None	None	$\frac{3}{8}$ "	
28"	3	1"	None	None	1 $\frac{3}{8}$ "	
30"	3	1"	1"	1"	1 $\frac{3}{8}$ "	
32"	3	2"	1"	1"	2 $\frac{3}{8}$ "	

* 24" glow batons can also fit 22 inch glow necklaces inside the shaft.